

BRIDGE INVENTORY INFORMATION

Inventory Information

- On inspection forms to assist inspector
- Sources
 - Transportation Infrastructure Management System (TIMS)
 - Inspectors add new data, verify existing or revise as required
 - future pick lists for addition or revision

How Are Bridges Identified?

- **Bridge File Number** (99999) assigned to each bridge site
 - 5 digit number
 - leading zeros, eg. **00987**
 - assigned in sequence
 - example: 75555
- **Structure Number** (99) assigned to each bridge at site
 - example: **1, 2, 3, etc.**

How Are Bridges Identified? continued

- **Visual Identifiers**
 - Travel Direction
 - Structure Type
 - blank = Two Way Traffic
 - N = Northbound Structure
 - EC = Eastbound Collector
 - ZNC = Sign Structure on Northbound Collector
 - example: **75555-ZNC-3**
- **Year Built**
 - First year substructure or barrel built
 - Second year superstructure fabricated

Where is the Bridge?

- Bridge Name or Nearest Town
 - bridge official name
 - nearest town on road map
- Located Over
 - Watercourse, Road, Railway, etc.
- Located On
 - Highway or Local Road
 - Includes Control Section (2.03)
- Contract Maintenance Area
 - Highways

Watercourse Designations

- Water Body Class & Year
 - future
 - water class of the watercourse
 - year designated by Environment
- Navigable Waters Class & Year
 - future
 - Navigable Class of Stream
 - Year Classified

Where is the Bridge?

- Legal Land Location
 - ie WNW 22 - 028 - 03 - 5

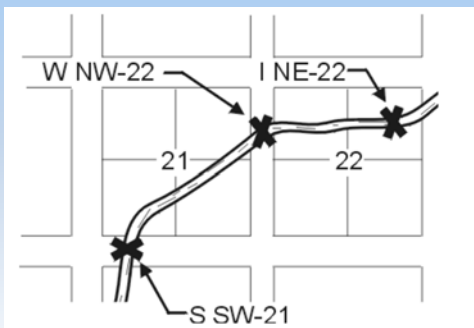

- Prefix is always W, S or I
- Longitude Latitude - Future

Road Authority

- Alberta Transportation (AT)
- County or Municipal District (C01 or M36)
- Town or Village (T or V)
- City (USA stands for Urban St Albert)
- Municipal Affairs (MA)
- Federal Government Departments (FIA)
- Private (P)

What is Clear Roadway?

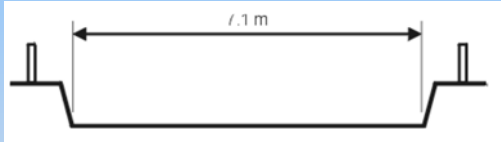

- Typical Bridge Clear Roadway = 7.1 m

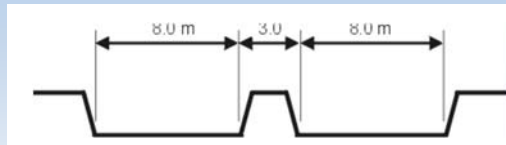

- Bridge with Median Clear Roadway = 16.0 m
- No curbs, measure inside rails

Average Annual Daily Traffic

- Field is three parts ie.150/2005 (E)
- Traffic Volume 150
 - Count adjusted for time of day & month
- Year 2012
 - year count taken
- Type of Traffic Count (E) or (A)
 - “A” is actual from inventory
 - “E” is estimate by inspector

What is the Road Classification?

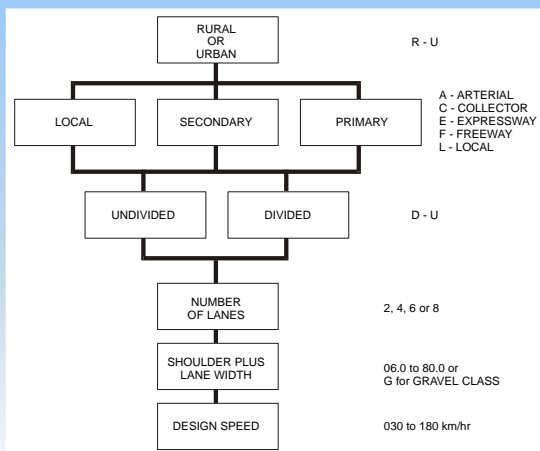

What is the Road Classification?

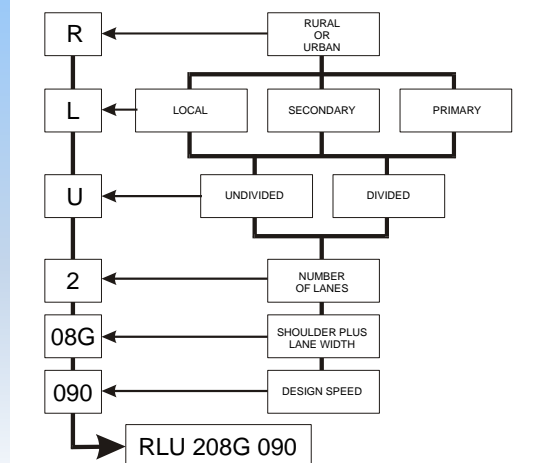

What is the Road Classification?

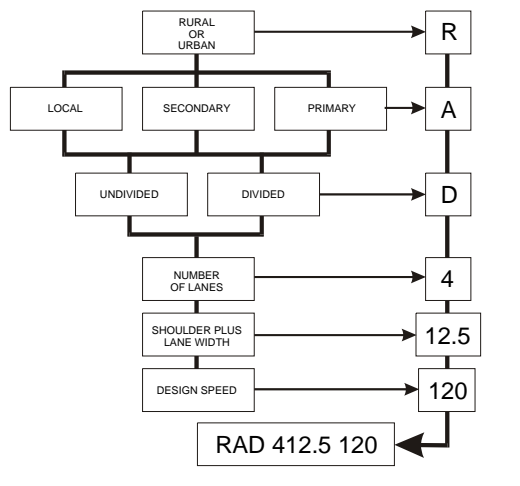

Standard Road Classifications

- Local Roads (gravelled)
 - RLU-207G-60
 - RLU-208G-60
 - RLU-208G-90
 - RLU-209G-90
 - RLU-210G-90
- Local Roads (paved)
 - RLU-208-100
 - RLU-208-110
- Provincial Highways
 - RCU-208G-090
 - RCU-209G-090
 - RCU-208-110
 - RCU-209-110
 - RCU-210-110

What is the Detour Length?

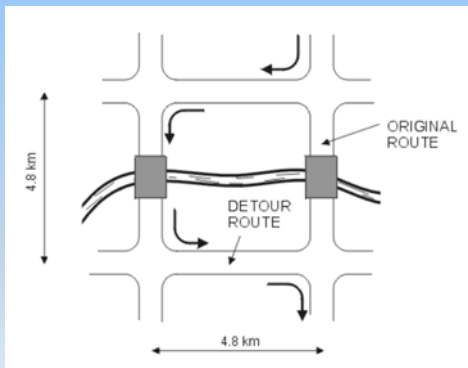

Detour length is extra distance traveled = 9.6 km

What is the Detour Length?

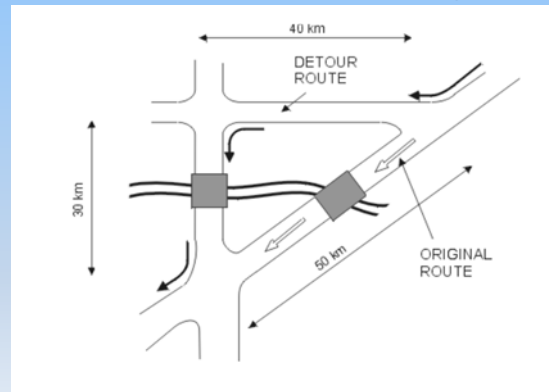

Detour length is the extra distance traveled = 40 km + 30 km - 50 km = 20 km

What is Posted Clearance?

- Only on:
 - grade separation
 - pedestrian overpass
 - through truss
- Lowest measured clearance between road and bridge less tolerance
- Calculation
 - Minimum measured clearance = 4.88 m
 - Tolerance = 0.10 m
 - 4.78 m
 - Round down to nearest decimeter = 4.7 m
(1/10th of a metre)
 - BIM Required Vert. Clearance Posting = 4.7 m
 - TIMS Data = 4.8 m

Bridge Details

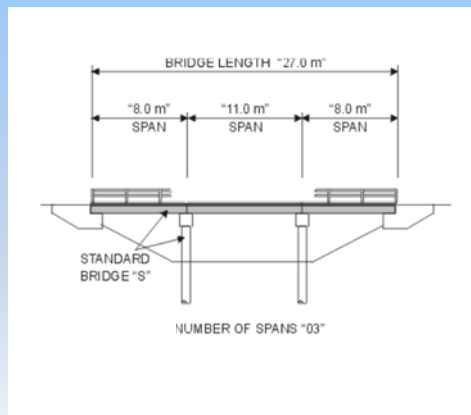

Bridge Components

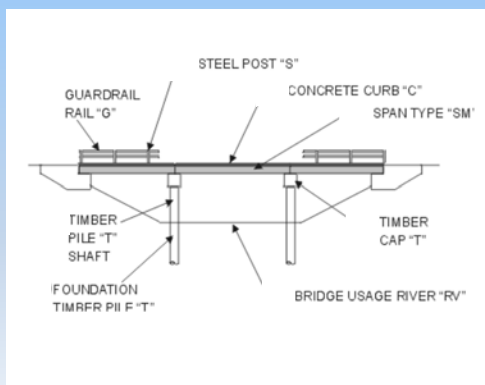

Bridge Components

